

How to change personal information

Login

1. Access website www.cuhk.edu.hk, and then click MyCUHK.

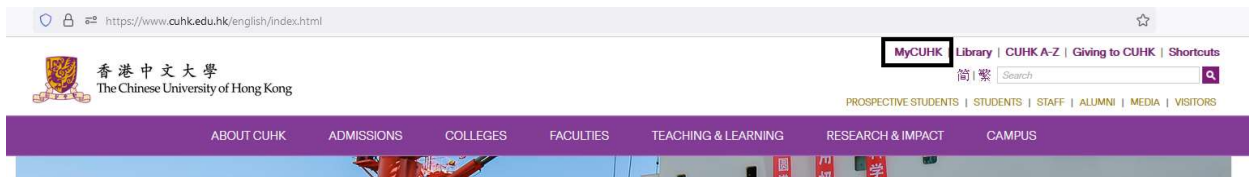

2. Login using account: alumniid@link.cuhk.edu.hk and password. Then click Sign In.

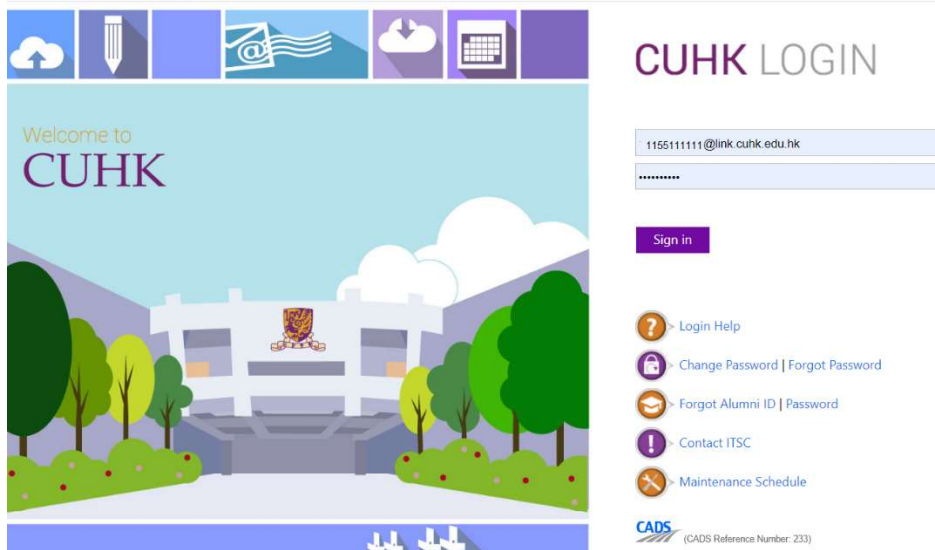

3. Click MyPage

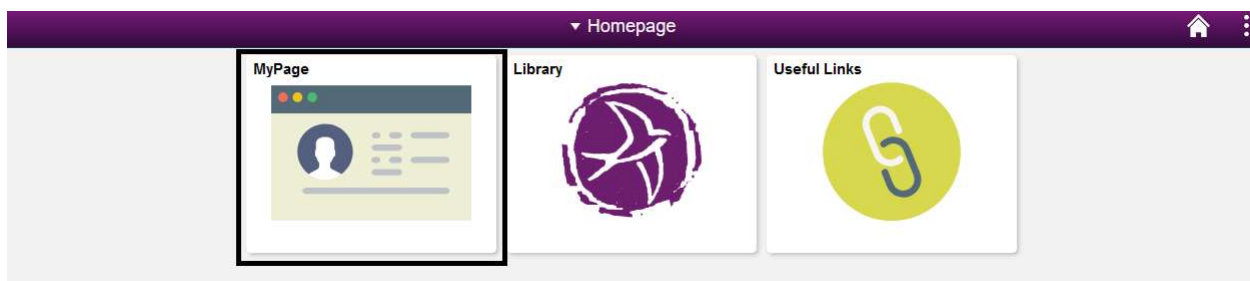

Change address

1. Click Addresses

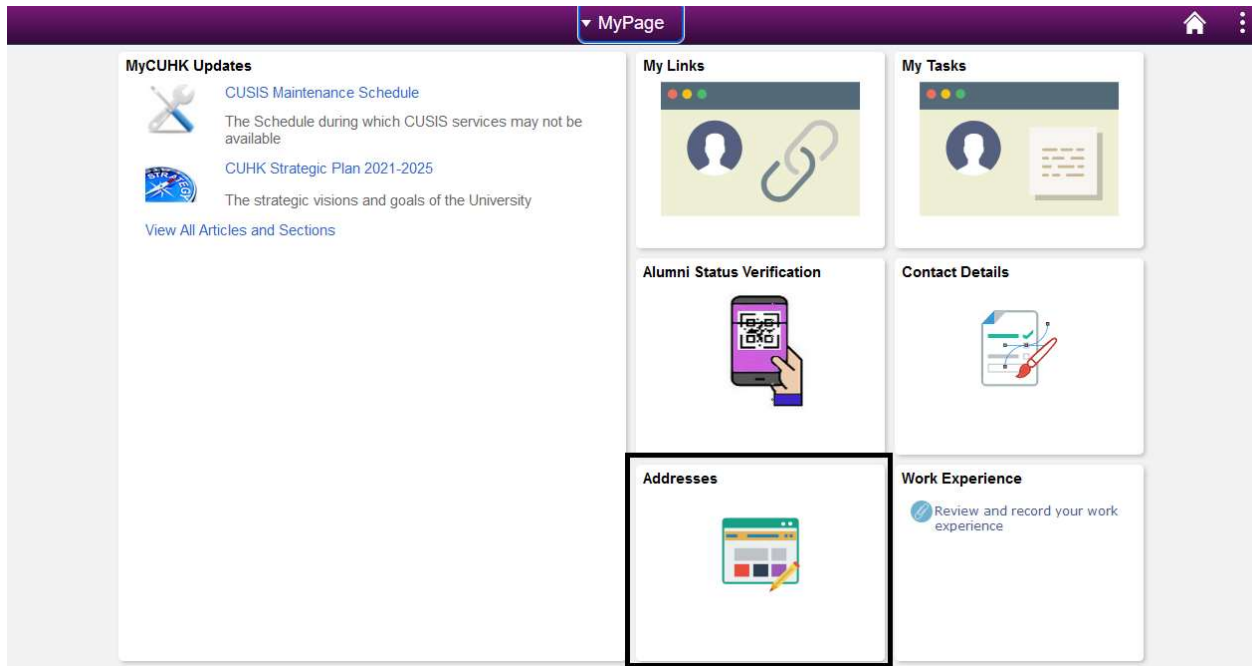

2. Click '>'

Addresses

Home Address

No address defined

[Add Home Address](#)

Mailing Address

+	
Address	From
fld*****	
hfx*****	
fb *****	
Tai*****	Current
NT*****	
Hon*****	

Business Address

No address defined

[Add Business Address](#)

3. Choose 'Country/Region' by clicking the 'Q'

Cancel **Edit Address** Save

Type Mailing

*From 30/06/2022

*Country/Region Hong Kong SAR, China **Q**

*Flat/Floor/Bloc

Building Name

Street Name

District **Q**

HK/KLN/NT

4. In the Description box, input the name of the Country/Region, and then click 'Search'.
Click to the correct Country/Region under Search Results.

Cancel **Lookup**

Search for: Country/Region

▼ **Search Criteria** [Show Operators](#)

Country/Region (begins with)

Description (begins with) Hong Kong

Search Clear

▼ **Search Results**

1 row

Country/Region	Description
HKG	Hong Kong SAR, China

5. If there is 'Q' next to the input field, please click the 'Q' to search and select the address information.

Cancel **Edit Address** Save

Type Mailing

*From 30/06/2022

*Country / Region China **Q**

Postal

Province **Q**

City

*Address 1

Address 2

Address 3

Address 4

Cancel **Edit Address** Save

Type Mailing

*From 30/06/2022

*Country / Region USA **Q**

*Address 1

Address 2

Address 3

City

State **Q**

Postal

County

6. Click 'Save' after inputting the full new address.

Type Mailing	
*From	30/06/2022
*Country/Region	Hong Kong SAR, China <input type="button" value="Q"/>
*Flat/Floor/Bloc	Flat A
Building Name	Sha Tin Building
Street Name	Sha Tin Street
District	Sha Tin <input type="button" value="Q"/>
HK/KLN/NT	NT

Change Alumni Communication email

1. Click Contact Details

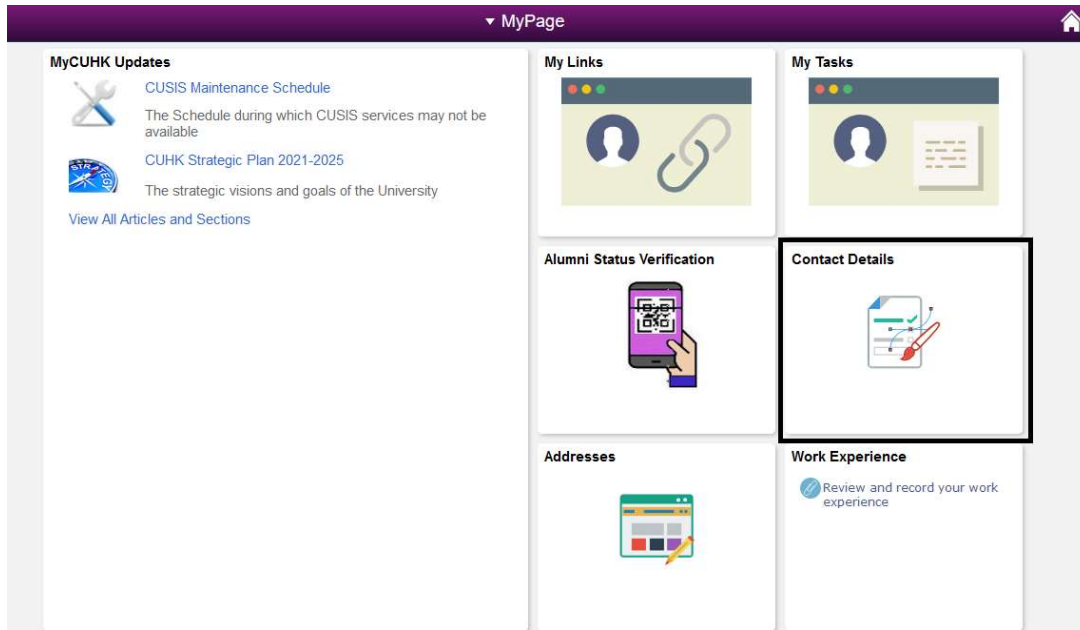

2. Click '>' to change the Alumni Communication email

Contact Details

Email

Please note that for active student, ALL official communications from The Chinese University of Hong Kong ('CUHK') will be sent to your email address listed as a 'Campus' email type.

For alumni users, University communication emails will be sent to your "Alumni Communication" email address.

+	
Email	Type
XXX*****@lwx*****	Campus >
XXX*****@hjt*****	Other >

Phone

+		
Phone	Type	Preferred
822*****	Mobile (HK)	✓ >
822*****	Other	>

3. Input new email and click 'Save'.

Edit Email

Type Alumni Communication

*Email
